



Hamaton

Innovation to Perfection

TPMS Product Brochure





ABOUT HAMATON

Hamaton Automotive Technology Co., Ltd. is a world-leading manufacturer of tyre valves and tyre pressure monitoring system (TPMS) products for the OE and aftermarket. Hamaton Ltd. (UK) and Hamaton GmbH (Germany) operate as specialist distribution centres, enabling the company to deliver its comprehensive product range to organisations across Europe.



TPMS PRODUCT RANGE

The Hamaton product range, manufactured in an OE environment to certified standards, includes the EU-Pro family of universal sensors, replacement parts and workshop tools.

Additionally, Hamaton offers ATEQ diagnostic tools and a collection of its own branded tools developed in partnership with the manufacturer, such as the H57 and Hybrid HT.

UNIVERSAL SENSORS



The NFC-Enabled Universal Sensor



What Sets this Sensor Apart?

Users can configure and program this sensor with their smartphones.

This solution is perfect for workshops, wheel assemblers and companies looking to capitalise on TPMS business opportunities.



What is NFC?

NFC is a short-range wireless technology that allows compatible devices to communicate. Its most common use on a smartphone is making quick and easy payments with Apple Pay or Google Pay.

NFC Benefits & App Features

Superfast Configuration

Our dedicated app configures Hybrid NFC sensors in just one tap, outperforming traditional diagnostic tools.*

Two Ways to Configure

Create a new ID and use any diagnostic tool to relearn a vehicle. Alternatively, manually enter an existing OE sensor ID and skip the relearn process altogether.

No Potential for Error

Users can be rest assured they have configured the correct sensor thanks to the short-range transmission of NFC.

Free to Download & Update

Say goodbye to subscription fees and manual updates. The app updates automatically, so users do not have to!** These real-time updates ensure the latest vehicle coverage will always be at your fingertips.

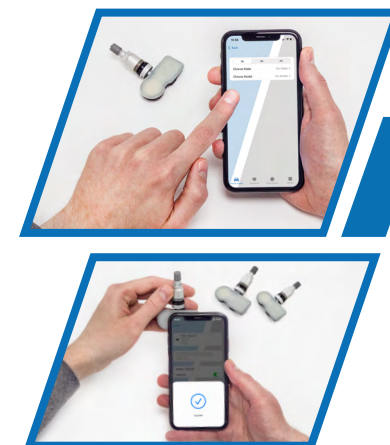

Besides NFC, the EU-Pro Hybrid NFC includes the same features as the Hybrid 3.5 (on page 3).

Silver Clamp-In: [HTS-A71BM](#)

Black Clamp-In: [HTS-A71BN](#)

Snap-In: [HTS-A71BA](#)

Graphite Clamp-In: [HTS-A71BP](#)

*Available for NFC-enabled Android phones and the iPhone 7 or newer with a minimum of iOS 15.

**Mobile data or a Wi-Fi connection is required.

UNIVERSAL SENSORS



**Configurable & Programmable
Universal Sensors**

- **Configurable:** configure in 1-3 seconds, as protocols covering a high percentage of known vehicles are stored on the sensor
- **Programmable:** add new protocols as they become available, future-proofing stock
- Compatible with leading diagnostic tools, including those manufactured by ATEQ
- Designed for an optimal fit with OE and aftermarket wheels
- Powerful Maxell battery and the latest NXP chip
- 3-year sensor warranty*

Silver Clamp-In: [HTS-A68BM](#)
Black Clamp-In: [HTS-A68BN](#)

Snap-In: [HTS-A68BA](#)
Graphite Clamp-In: [HTS-A68BP](#)



*Sensors have a 3-year warranty, valves are warranted for two years.
Valves must be serviced/replaced when the tyre bead is broken to uphold the sensor warranty.

TESLA BLE SENSOR



The EU-Pro Hybrid BLE is a direct replacement for the Sysgration (Bluetooth Low Energy) BLE sensor used by Tesla vehicles. This aftermarket solution employs BLE to alert the ECU when tyre pressure drops, and is pre-programmed, enabling technicians to skip the programming step.

Coverage:

- Tesla Model 3 (Oct 2020+)
- Tesla Model S (Jun 2021+)
- Tesla Model X (Oct 2021+)
- Tesla Model Y (Oct 2020+)

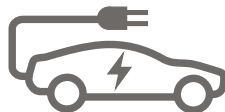

Silver Clamp-In: [HTS-B10BM](#)

Black Clamp-In: [HTS-B10BN](#)

Graphite Clamp-In: [HTS-B10BP](#)

OE REPLACEMENT SENSORS

OE-R

- Cost-effective solution to replace Original Equipment (OE) sensors
- No programming required - fully functional following a TPMS relearn procedure
- Designed for an optimal fit with OE and aftermarket wheels
- Powerful Maxell battery and the latest NXP chip
- 3-year sensor warranty*



*Sensors have a 3-year warranty, valves are warranted for two years.
Valves must be serviced/replaced when the tyre bead is broken to uphold the sensor warranty.

VALVE OPTIONS FOR HAMATON SENSORS



Silver Clamp-In:
[6-266B](#)



Snap-In:
[6-207](#)



Black Clamp-In:
[6-266B-BK](#)



Graphite Clamp-In:
[6-266A-SH](#)

The EU-Pro family of sensors have four valve stem options: our most popular aftermarket Snap-In and three Clamp-In valves designed to complement alloy wheels.

BUNDLE OFFERS*

Our fantastic bundle deals combine the H47/57 TPMS diagnostic tools with our configurable and programmable Hybrid 3.5 sensors.

Bundle options include:

- Hamaton H47 or Hamaton H57 TPMS diagnostic tool
- 8, 16 or 24 Hybrid 3.5 sensors

You can mix and match the valve stems. Choose from Silver Clamp-In, Black Clamp-In, Graphite Clamp-In and Snap-In.**

**FIND OUT MORE ON OUR BUNDLES PAGE
ON THE HAMATON WEBSITE**



*Available while stocks last.

**Please specify which valve stems you want in the extra information box at checkout, or the quantity will be split equally between Silver Clamp-In and Snap-In.

DIAGNOSTIC TOOLS

Standard Features

- Read and activate 100% of OE and aftermarket sensors
- Manually enter IDs and copy a set of wheels
- Retrieve IDs from the ECU*
- Unlock the ECU*
- Manual relearn procedures
- ATEQ's Live Sensor platform (updates sensor information in real-time)
- ATEQ's Sync-ID technology (increases OBDII relearn coverage to over 90%)*
- Remote Key Entry (RKE) test
- A sensor part number directory
- Easy-to-use icon-driven navigation and a comprehensive language selector



Hamaton and ATEQ Diagnostic Tools | The Differences

	Hamaton	ATEQ
Configure/Program	EU-Pro Hybrid and T-Pro Hybrid Sensors	All Popular Universal Sensors
Multi-programming	EU-Pro Hybrid and T-Pro Hybrid Sensors	All Popular Universal Sensors
Free Software Subscription	5 Years	1 Year (VT37 & VT67) 3 Years (VT57)
Warranty	2 Years	1 Year (VT37 & VT57) 2 Years (VT67)

The Hamaton H57** and Hybrid HT can be upgraded to configure/program other universal sensors. See page 9 for more information.

Additional Features Per Diagnostic Tool

ATEQ VT67

- 8" colour touchscreen
- Bluetooth ready
- Update via Wi-Fi
- Customer management
 - Capture images of vehicle parts
 - Email TPMS reports
 - Storage: 12GB
- TPMS diagnostics
 - Retrieve DTCs
 - ID Match (compare sensor IDs to the ECU)
- Tyre management
 - Record DOT codes (date and place of tyre manufacture)
 - Change tyre pressure placard value
 - Measure tyre tread depth***
- Vehicle databases: Australasia, Europe, Japan and North America
- OBDII port locations
- OBDII connector included



PN: ATE-D084

*Excludes the ATEQ VT37.

**If users upgrade the sensor coverage, the subscription period will revert to the remaining time offered with the equivalent ATEQ tool.

***Tyre Tread Depth Gauge sold separately.



PN: ATE-D081



PN: HAM-D076



PN: HAM-D065

- 2.8" colour display
- Tyre management
 - Change tyre pressure placard value
- Vehicle databases: Europe, Eurasia and North America
- OBDII connector included

ATEQ VT57 & Hamaton H57

- 4.3" colour touchscreen
- Update via Wi-Fi
- Customer management
 - Store up to 800 service records
- TPMS diagnostics
 - Retrieve DTCs
- Tyre management
 - Record DOT codes (date and place of tyre manufacture)
 - Change tyre pressure placard value
 - Measure tyre tread depth*
- Vehicle databases: Australasia, Europe, Eurasia, Japan, Korea and North America
- OBDII port locations
- OBDII module and connector included



PN: HAM-D081

Hamaton Hybrid HT

- 2.8" colour display
- Update via Wi-Fi
- Customer management
 - Store up to 800 service records
- TPMS diagnostics
 - ID Match (compare sensor IDs to what is on the ECU)
- Tyre management
 - Change tyre pressure placard value
 - Measure tyre tread depth*
- Vehicle databases: Australasia, Europe, Eurasia and North America
- OBDII connector included



PN: ATE-D079

- 2.8" colour display
- Vehicle databases: Australasia, Europe, Eurasia and North America



*Tyre Tread Depth Gauge sold separately.

COMMERCIAL VEHICLE TPMS



PN: HTS-T01A



Our simple and easy to use Truck 1.0 TPMS solution fits seamlessly into your existing tyre changing processes, and is compatible with both OE and aftermarket Truck TPMS valves.

- Mandatory for new M1, M2, M3, N1, N2, N3, O3, O4 EU vehicle registrations from July 2024
- European database of trucks, trailers, and buses, with new protocols automatically added
- Compatible with ATEQ's VT Truck 2.0, and H56/57, VT56/57 tools with a truck upgrade
- 24-month warranty or 100,000-km, whichever comes first.
- Cutting-edge battery and the latest NXP chip
- 433MHz frequency required for EU TPMS systems

Compatible Valves:

6-460 | 6-461 | 6-462 | 6-463 | 6-464 | 6-465



PN: ATE-D091

ATEQ VT Truck 2.0 with OBD Power Converter

The ATEQ VT Truck 2.0 offers a range of functions specifically designed for the maintenance of trucks, buses, coaches, trailers, and light trucks.

- 2.8" colour display
- Program aftermarket sensors designed for heavy-duty commercial vehicles
- Global database for trucks, buses, coaches, trailers, and light trucks
- Easily read sensors, even in twin wheels, up to 22 wheels
- Tyre management
 - Measure tyre tread depth*
- OBDII capability for on-board diagnostics
- WiFi & real time updates, powered by Live Sensor™
- One-year software subscription

*Tyre Tread Depth Gauge sold separately.



H57: HAM-D097 | **VT57:** ATE-D097
H56: HAM-D096 | **VT56:** ATE-D096

ESSENTIAL TOOLS FOR SERVICING

The tool kit and carry case is an essential piece of equipment for garages, workshops and tyre bays, as it contains all the tools required to service valves successfully.

- The tool range is compatible with every valve on the market
- Overcome varying torque settings among valves and service kits by having the correct tool to hand, reducing the risk of damage and servicing times

Contents:

- Calibrated torque tool, including:
 - 7mm, 11mm and 12mm hex sockets
 - 10, 15 and 20 Torx bits
- Valve core torque tool
- Grommet removal tool
- T6 Torx screwdriver

PN: 6-313



STARTER KIT PRO

The Starter Kit Pro contains a selection of the most popular replacement parts, which cover 99% of European direct TPMS-enabled vehicles.

With 52 valves and 12 service kits (for OE and aftermarket sensors), the Starter Kit Pro removes the worry of not having the correct replacement parts to hand.

For extra convenience, the Starter Kit Pro's contents are available in individual boxes of 10.

PN: 6-348



Truck Upgrades | Hamaton H56/57 & ATEQ VT56/57

Diagnostic tool users can purchase a truck upgrade, enabling them to read and diagnose TPMS systems on commercial vehicles.

This upgrade allows users to service both passenger and commercial vehicles without investing in another tool. Upgrading your tools unlocks a separate menu solely dedicated to commercial vehicles, including many features ideal for TPMS maintenance.

Includes:

- Software Upgrade
- OBD Power Converter
- +1 Year Software Updates

Find the Correct Replacement Parts Online

The Hamaton website is home to our Vehicle Look-Up tool designed to help users quickly identify replacement parts for their vehicle. Just enter the make, model and year of manufacture to begin your search.

UK: www.hamaton-tpms.com

DE: www.hamaton-tpms.de

OPTIONAL UPGRADES & ADD-ONS

Tyre Tread Depth Gauge

This ergonomic tool accessory quickly captures three precise depth measurements (inner, centre and outer) of up to seven tyres per vehicle.

Identifying a worn tyre enables garages to upsell replacement tyres, improves road safety, and reduces the risk of accidents.

Compatible with the VT67, VT57, H57 and Hybrid HT diagnostic tools.

PN: [ATE-D027](#)



Universal Sensor Upgrade

Increase the universal sensor coverage of your Hamaton diagnostic tool to include the following brands: ALCAR Sensor, ALLIGATOR Sens.it, BH SENS IntelliSens, VDO REDi-Sensor and SCHRADER EZ-sensor.

Compatible with following diagnostic tools: H57* and Hybrid HT.

*If users upgrade the sensor coverage, the subscription period will revert to the remaining time offered with the equivalent ATEQ tool.

Software Updates

Having a valid software subscription and keeping diagnostic tools updated is essential. Software updates provide new features and increased coverage meaning garages can service more vehicles.

If your software licence has expired or is ending soon, contact us to discuss your options.

Install WebVT to download the latest software update. VT67, VT57, H57 and Hybrid HT owners can perform subsequent updates via Wi-Fi.

www.hamaton-tpms.com/webvt



ONLINE SHOP & SUPPORT

On our website, visitors will find answers to the most asked questions surrounding TPMS and a [downloads page](#), including fitment instructions, how-to guides and product comparison charts. Scan the QR code to check out this page.

Unlock Exclusive TPMS Info Plus Much More with Just a Login

Besides up-to-date coverage of our TPMS product range, users can take advantage of step-by-step relearn procedures for countless vehicles. This industry-leading data will be a blessing to anyone fitting a new sensor and help ensure the vehicle's TPMS is in good working order.

Our online shop allows users to place an order whenever is convenient for them. Users will also gain access to (account specific) live pricing and their purchase history.

LET'S STAY CONNECTED

Follow our social media channels or visit our website to and be among the first to hear the latest business and product news.



Hamaton | Innovation to Perfection



UK: www.hamaton-tpms.com

DE: www.hamaton-tpms.de



UK: info@hamaton-tpms.com

DE: info.gmbh@hamaton-tpms.com

